

Prometheus

Electronic Piezo Lighters



Prometheus electronic piezo lighters have a built-in electronic piezo inside of the lighter. When the ignition button of the electronic piezo lighter is pushed down, butane gas is released from the gas tank and at the same time, an electronic spark is generated. When butane gas and electronic spark come in contact, flame is generated. The turning of the spark wheel of the flint lighters could be hard on your thumb. The electronic piezo lighters have been the choice of smokers who do not like turning the spark wheel of the flint lighters and who prefer visible soft flame to the invisible, strong flame generated by torch flame lighters.

Please note that the paucity of oxygen at a high altitude can prevent the electronic piezo of torch flame and electronic piezo lighters from functioning properly. Please use the flint lighters in a high altitude region such as Swiss Alps, Mexico City, Colorado (U.S.A.) and New Mexico (U.S.A.).



Juliet

electronic piezo, glass plated
dimensions: 3.1 inches x 0.7 x 0.4 (79 mm x 19 x 11)



SL



BL



YL

Martiz

electronic piezo
dimensions: 2.4 inches x 0.9 x 0.6 (60 mm x 20 x 16)



SL



PK



BL



YL

Karen

electronic piezo, glass plated

dimensions: 3.6 inches x 0.5 x 0.5 (92 mm x 13 x 13)



SL



PK



BL



YL

Slimline

electronic piezo

dimensions: 2.5 inches x 1.2 x 0.4 (64 mm x 31 x 10)



01

satin nickel



02

satin gun metal



05

black matte



07

metallic blue

Xenon

electronic piezo

dimensions: 2.9 inches x 1.0 x 0.5 (4 mm x 26 x 12)



02

gun metal



03

chrome / black matte



04

chrome



05

black matte

Sherlock

electronic piezo with built-in pipe tamper
dimensions: 2.9 inches x 1.2 x 0.6 (75 mm x 31 x 15)



03



02



05



07

Lord

electronic piezo

dimensions: 3.0 inches x 1.4 x 0.6 (75 mm x 35 x 15)



01
satin nickel



07
metallic blue



02
satin gun metal



04
satin chrome



4A
polish chrome

Allegro

electronic piezo

dimensions: 2.4 inches x 1.4 x 0.7 (61 mm x 35 x 17)



01



02



03



04

Arvado

electronic piezo

dimensions: 2.4 inches x 1.3 x 0.6 (60 mm x 33 x 15)



02
gun metal



04
black matte

Prometheus

Flint Lighters



When you open the cap of the flint lighters, butane gas from the gas tank is automatically released. When you turn the spark wheel of the flint lighters, the spark wheel turns against flint, a tiny stone. The friction between the spark wheel and flint generates spark. When butane gas meets this spark, flame is ignited. After you use the flint lighters, you must close the cap in order to extinguish the flame and also, to prevent butane gas from evaporating. Some smokers prefer the flint lighters because:

- 1) the flame is visible
- 2) once the flame is ignited, the flame will stay on even though you do not continuously hold down the ignition button of the lighter.

The paucity of oxygen at a high altitude can prevent the electronic piezo of the torch flame and electronic piezo lighters from functioning properly. Please use Prometheus flint lighters in high altitude regions such as Swiss Alps, Mexico City, Colorado (U.S.A.) and New Mexico (U.S.A.).

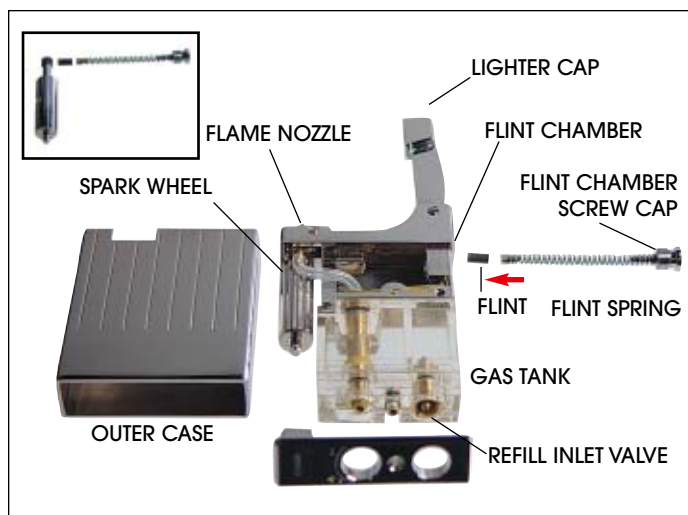

Churchill X

palladium-plated

dual-flame, flint **with punch cutter**

dimensions: 2.4 inches x 1.5 x 0.4 (62 mm x 37 x 11)



X1
vertical / palladium



if you need a larger cut, you can punch two holes on the head of the cigar.
Prometheus Churchill with a built-in, punch cutter
(U.S. Patent 6,298,856 & 6,732,741)



X2
horizontal / palladium



X3
shaper cut / palladium



X4
crisscross / palladium

Churchill II

palladium-plated

dual- flame, flint **without punch cutter**

dimensions: 2.3 inches x 1.5 x 0.4 (58 mm x 37 x 11)



22

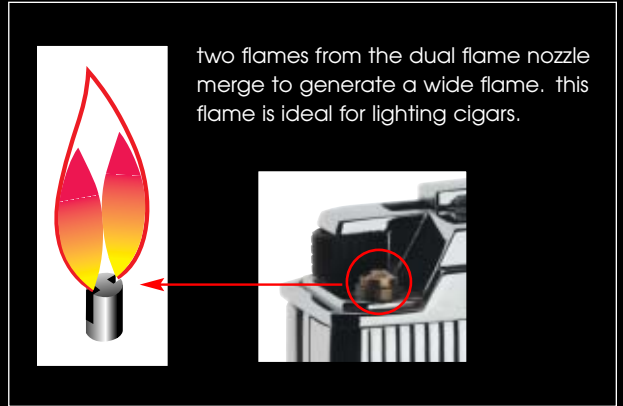

21



23



24

Churchill II

palladium-plated

dual flame, flint

dimensions: 2.3 inches x 1.5 x 0.4 (58 mm x 37 x 11)



27



two flames from the dual flame nozzle merge to generate a wide flame. this flame is ideal for lighting cigars.

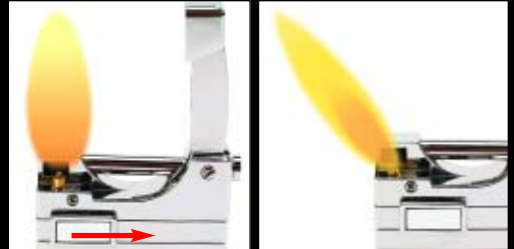

push the button on the back of the lighter to the right to convert the vertical flame to the angled flame to light pipe.



25



26



28

Prince

dual flame, flint

dimensions: 2.7 inches x 1.1 x 0.4 (69 mm x 28 x 12)



02
barley

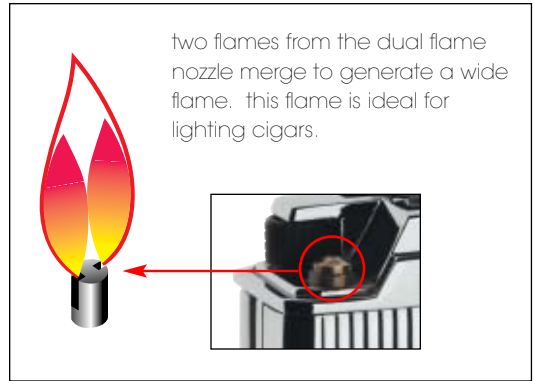

01
vertical



03
wave



04
lacquer

Prometheus



XM

dual flame, flint **with punch cutter**

dimensions: 3.0 inches x 0.7 x 0.5 (76 mm x 19 x 13)



03
barley

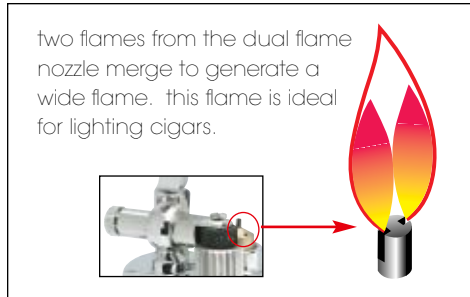

two flames from the dual flame nozzle merge to generate a wide flame. this flame is ideal for lighting cigars.



if you need a larger cut, you can punch two holes on the head of the cigar.

Prometheus XM with a built-in, punch cutter
(U.S. Patent 6,298,856 & 6,732,741)



01
vertical



02



04



07



08

Promethes



Barron

flint **with pipe tamper and punch cutter**

dimensions: 2.5 inches x 1.4 x 0.5 (69 mm x 28 x 13)



01



45 degree flame



Barron comes with pipe
tamper and punch cutter.

Prometheus Barron with a built-in, punch cutter
(U.S. Patent 6,298,856 & 6,732,741)



purchase a Barron
lighter and get a free
leather pipe tobacco
pouch in a gift set
box. only available
at participating
Prometheus dealers.



02



03



04

Imco

actual size / flint
30 day warranty only



minimum purchase: 12 pieces in a tray

Bentley

actual size / flint with pipe tamper
30 day warranty only



minimum purchase: 24 pieces in a tray

Tribus

actual size / flint
30 day warranty only



minimum purchase: 24 pieces in a tray

Butane and Flint



Flint-P



Refill-P

triple refined butane gas
1.76 oz. / .50 grams

Display-P96

4 sided floor display with wheels and storage cabinet

dimensions:

25 inch W x 25 L x 71 H

64 cm W x 64 cm L x 180 cm H



Display-P30

3 sided counter top display

dimensions:

13.5 inches W x 13.5 L x 29.75 H

34 cm W x 34 cm L x 76 cm H

Glass Tower

4 sided floor display with wheels and storage drawer

dimensions:

23 inches W x 23 L x 76 H

58 cm W x 58 L x 193 H





H-Display

dimensions:
4.63 inch x 3.00 x 2.00 (117 mm x 78 x 52)
weight: 0.25 lb (0.10 kg)



D-Stairs/20

dimensions:
18.5 inch x 8.68 x 2.81 (470 mm x 220 x 71)
weight: 3.55 lb (1.62 kg)

D-Stairs/10

dimensions:
10 inch x 8.63 x 2.75 (254 mm x 219 x 70)
weight: 3.00 lb (1.36 kg)



D-Stairs/18

dimensions:
10 inch x 13.5 x 4.33 (254 mm x 245 x 110)
weight: 6.75 lb (3.06 kg)



Acrylic Displays



D-Stand/C
Cigar case stand



D-Block/L
10 inches x 10 in
(254 mm x 254 mm)



D-Block/M
8 inches x 8 in
(203 mm x 203 mm)

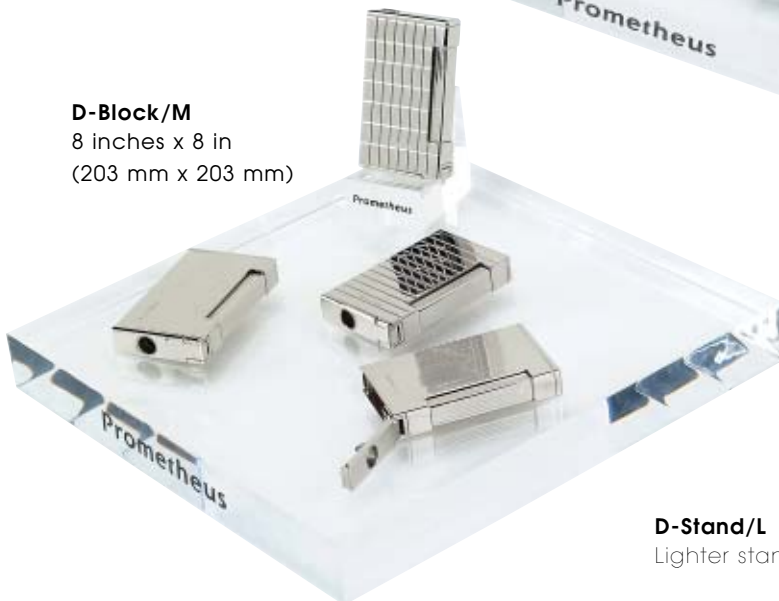

D-Stand/L
Lighter stand



Prometheus

1 9 9 2 - 2 0 0 7

15th Anniversary

Prometheus stole fire from Zeus, the king of Olympian Gods, to bring it to mankind. Enraged Zeus ordered Prometheus to be bound to a desolate rock and attacked by an eagle. Prometheus was punished with a tragic death for his love of mortals. *The Prometheus Bound* (the painting in the front cover) portrays his unwavering endurance of suffering. Prometheus is a courageous hero for mankind.

Prometheus International, Inc.

6231 Bandini Boulevard, Commerce, California 90040-3113, U.S.A.

Telephone (323) 869-9200 Facsimile (323) 869-9288

E-mail) prometheus@prometheuskp.com