



Carlito Fuente lighting *God of Fire by Carlito, Double Robusto 2005* with Prometheus Liquid Lighter at the 2006 God of Fire dinner at Hotel Bel-Air on October 7, 2006. Over \$200,000.00 was raised at the dinner for Cigar Family Charitable Foundation. The foundation was established by the Fuente and Newman families to provide better education and living standards for the poor children in Dominican Republic.

# Prometheus

Prometheus lighters are available in three different mechanisms.

---

**Torch Flame** . . . . . (Page 106 - 145)

**Electronic Piezo** . . . . . (Page 146 - 152)

**Flint** . . . . . (Page 153 - 163)

All Prometheus lighters come with Limited Two-Year Warranty (page 95).



[www.prometheuskkp.com](http://www.prometheuskkp.com)

# Prometheus

1992 - 2007

15th Anniversary

2007 is the 15th anniversary of the Prometheus brand. Currently, Prometheus offers a full collection of accessories for cigar lovers: crystal ashtrays, humidors, cutters, wallets, watch boxes and more. Our sister



1992, Victor



1995, Neptune and Renoma



1997, Robusto and Esplendido



1999, Magma

company, God of Fire, even offers vintage, aged cigars. However, in 1992, we started out as a lighter company and the lighter segment of our business has a very special place in our heart. The history of Prometheus lighters represents cutting-edge designs and groundbreaking innovations. After 15 years, everyone at Prometheus is still very passionate about making lighters and excited about continuing our tradition of innovation and creative design.



2000, Saturn



2001, Gladiator S



2004, Ultimo X



2006, Traveler

# Prometheus

**1992 - 2007**  
15th Anniversary

After 15 years, we are still crazy about making lighters, and continuing our tradition of innovation and creative design. The below are the pictures of the quality control staff at Prometheus International, Inc. in Commerce, California. All lighters are individually inspected before they are shipped to our dealers in 25 countries.





# Prometheus

Prometheus lighter factory in Incheon, Korea



# Prometheus

## Limited Warranty

**Please do not return the lighter to the store but directly to Prometheus Service Center for the warranty service.**

**Prometheus International, Inc. offers a limited warranty and warranty service on your lighter, as described below. We therefore ask that you return the product to Prometheus Service Center rather than to the retail store in the event of a malfunction.**

**Current Production Models:** Prometheus International, Inc. ("the Company") warrants that if your current production model Prometheus lighter malfunctions within two years from the date of original retail purchase, the Company will repair it upon submission of the lighter to Prometheus Service Center with original proof of purchase and payment of a shipping and handling fee, as described in the section below entitled "How to Obtain Warranty Service."

**Discontinued Models:** Prometheus International, Inc. ("the Company") warrants that if your discontinued model Prometheus lighter malfunctions within eighteen months of the official discontinuation date, the Company will repair it upon submission of the lighter to Prometheus Service Center with a copy of the original proof of purchase and payment of a shipping and handling fee, as described in the section below entitled "How to Obtain Warranty Service." A list of discontinued models and their official discontinuation dates can be found on the internet at <http://www.prometheuskkp.com/discontinued.htm>

### Exclusions:

1. This limited warranty does not cover the outer case mechanism and finish of your lighter (e.g., cap, hinge, etc.).
2. This limited warranty may be enforced only by the first consumer user; all subsequent purchasers acquire the lighter "as is" without any benefit of this limited warranty.
3. This limited warranty does not cover damage resulting from accident, misuse, abuse, tampering, neglect, or from other than normal and ordinary use of your lighter.
4. This limited warranty does not cover damage resulting from failure to clean or use your lighter in accordance with the manufacturer's instructions.
5. This limited warranty does not cover damage resulting from repair or attempted repair by anyone other than the Prometheus Service Center.

**Limitation of Implied Warranties and Exclusion of Certain Damages:** THE COMPANY DISCLAIMS LIABILITY FOR INCIDENTAL AND CONSEQUENTIAL DAMAGES FOR BREACH OF ANY EXPRESS OR IMPLIED WARRANTY, INCLUDING ANY IMPLIED WARRANTY OF MERCHANTABILITY, WITH RESPECT TO YOUR LIGHTER. THIS WRITING CONSTITUTES THE ENTIRE AGREEMENT OF THE PARTIES WITH RESPECT TO THE SUBJECT MATTER HEREOF; NO WAIVER OR AMENDMENT SHALL BE VALID UNLESS IN WRITING SIGNED BY THE COMPANY. Some states do not allow the exclusion or limitation of consequential damages, so the above limitation or exclusion may not apply to you.

**How to Obtain Warranty Service:** Please do not return the lighter to the store where you purchased it, but return it directly to the Prometheus Service Center. Drain all gas from your lighter and package it properly so that it will not be damaged during shipment. The Company recommends that you insure the shipment of your lighter and request proof of delivery. Prometheus Service Center is not responsible for lost, late, damaged, misdirected, or postage-due mail. For customers residing in the U.S., the Company recommends using Federal Express, UPS Regular Ground Service,

DHL, or Airborne Ground Service to ship the lighter to the Prometheus Service Center so that you can effectively track the package.

Please submit with the lighter with a copy of the original proof of purchase, the shipping and handling fee, the address to which the repaired lighter should be returned, your e-mail address, and a fax number or daytime telephone number. Failure to include the required fee will result in a SIGNIFICANT delay in the repair service. The address of the Prometheus Service Center is:

Prometheus Service Center  
6231 Bandini Blvd.  
Commerce, CA 90040-3113, USA  
Facsimile: (323) 869-9288  
E-mail: [Prometheus@prometheuskkp.com](mailto:Prometheus@prometheuskkp.com)

Please reference the following chart to determine the appropriate shipping and handling fee and acceptable form of payment:

Warranty Service Circumstances	Shipping and Handling Fee	Acceptable Forms of Payment
Within 45 days of purchase and with a dated purchase receipt	\$0	Not Applicable
Return address within the U.S., more than 45 days after purchase and with a dated purchase receipt	\$9	Check or money order made out to Prometheus Service Center.
Return address within the U.S., more than 45 days after purchase and without a dated purchase receipt	\$12	Check or money order made out to Prometheus Service Center.
Return address outside the U.S., more than 45 days after purchase	\$12	1. Check or money order made out to Prometheus Service Center; or 2. Credit card payment -- submit information regarding credit card holder, billing address, credit card number, and expiration date

**Please note that if the Company has to contact you to remind you to submit the S&H fee after you have sent your lighter in for warranty service, you will be charged an additional \$5 fee.**

Do not return your lighter in its original Prometheus gift box. The gift box will not be returned after the warranty service.

If you would like to check the status of your lighter warranty service, please submit your inquiry via the warranty status form, [http://www.prometheuskkp.com/warr\\_inquiry.htm](http://www.prometheuskkp.com/warr_inquiry.htm), or mail or fax it to Prometheus Service Center with your name, the address to which you requested the lighter be returned, and the date on which you sent your lighter in for warranty service. Note that the Company only responds to status inquiries as to lighters that were sent in more than 30 days prior to the status inquiry.

**WARNING: KEEP OUT OF REACH OF CHILDREN.** Lighter contains butane gas under pressure. Extremely flammable. Do not use near fire or flame. Do not puncture, incinerate, or expose to temperature above 120°F (49°C) or prolonged sunlight. Never leave lighter on dashboard or near window shelf of any vehicle. Hold away from face and clothing while lighting. **CAUTION: Be sure flame is extinguished after use.**

# Prometheus Lighter Maintenance Manual, Page 1 of 2



Prometheus lighters are not mass-manufactured by machines. Instead, they are carefully assembled by hand for quality and longevity. Please read this maintenance manual carefully to enjoy the best performance of your Prometheus lighter. If you have any question or need assistance, e-mail your inquiry to [Prometheus@prometheuskp.com](mailto:Prometheus@prometheuskp.com).

Prometheus lighters require the following simple maintenance to ensure proper performance.

**I. Refilling Lighters** If you use your Prometheus lighter every day, we recommend you to refill the lighter at least once a week. If you are not using the lighter frequently, refill the lighter when the gas level gets low. When the gas level gets low, the flame of your Prometheus lighter becomes weak or low, and it is time to refill the lighter. Your Prometheus lighter can be used over and over again if its gas tank is refilled with clean butane gas. The clean butane burning of Prometheus lighter does not generate unpleasant petroleum odor like oil fluid lighters and will enhance your smoking pleasure. For the best performance, please use finely refined Prometheus butane gas which can be purchased at premium tobacco shops worldwide. Please read the instructions below for proper refilling steps.

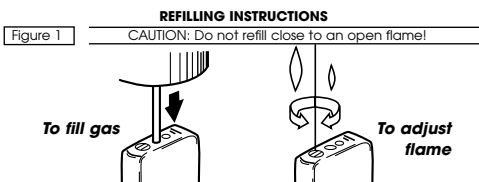

1. Extinguish the flame of your lighter.
2. In order to prevent an unexpected high flame after refilling, turn the flame height adjuster on the bottom of the lighter to the lowest setting by turning the adjuster clockwise with a small screwdriver.
3. Take the air out of the gas tank by pressing the refill inlet valve with a small screwdriver until no hissing sound is

heard. Hold the lighter away from face when taking the air out. The air in the gas tank prevents butane gas from being injected into the gas tank properly and causes the lighter to malfunction. If butane gas comes out of the inlet valve when the inlet valve is pressed, stop bleeding the gas tank immediately. In this case, the gas tank is filled with butane gas.

4. Refill the lighter in an upside down position as shown above.
5. After shaking the butane gas refill can, press the stem of the refill can directly onto the refill inlet valve on the bottom of the lighter and let butane gas go into the gas tank for about 10 seconds.
6. Do not ignite lighter for about 2 minutes until the butane gas in the gas tank reaches room temperature.
7. Open the flame height adjuster by a quarter turn at a time by turning counter-clockwise until the flame height reaches the desired level. Hold the lighter away from face when igniting. If the flame height adjuster is turned up too high, the lighter will not ignite and you will hear a hissing sound. If this happens, lower the adjuster by turning clockwise.
8. If the gas tank is empty, refill rather than turning the flame height adjuster higher.

**II. Adjusting Flame Height** The low or weak flame is caused by: 1) the empty gas tank, or 2) the low flame height setting. If the gas tank is empty, refill rather than turning the flame height adjuster higher. When the gas tank is empty, turning the flame height adjuster higher will cause the lighter to malfunction.

If the gas tank is full and your lighter ignites a weak or low flame, turn up the flame height adjuster on the bottom of the lighter to the desired level. Make sure to extinguish your lighter before turning the flame height adjuster.

High flame is dangerous to the safety of users as well as damaging to the proper functioning of the lighter. If the flame height adjuster is turned up too high, the lighter will not ignite and you will hear a hissing sound. If this happens, lower the adjuster immediately.

Inside of the lighter, there is a built-in stopper which sets the maximum and minimum levels of the flame height. Please do not try to turn the adjuster beyond the preset maximum and minimum levels. If you force the adjuster to turn, you will damage the built-in stopper and your lighter will malfunction. Please note that the excessively, frequent adjustment of flame height can damage the lighter. Please refer to Figure 1 above for the adjustment illustration.

**III. Falling Ashes will clog up your lighter.** In lighting your cigar or cigarette, please do not put them into the burning flame of the lighter. This will cause the ashes to fall into the flame hole of the lighter and clog up the lighter. Light them with the top tip of the flame. When you carry your lighter, make sure that the inside of your pocket is clean in order to prevent the flame hole from clogging up. Also, periodically, clean the flame hole with compressed air, which can be purchased at computer stores.

# Prometheus Lighter Maintenance Manual, Page 2 of 2

**IV. Construction** There are three types of Prometheus lighters: **Electronic Piezo, Flint, and Torch Flame lighters.** If you would like to know the type of your Prometheus lighter and its construction, visit our web site:

<http://www.prometheuskkp.com/construction.htm>

**V. Care and Handling of Prometheus Torch Flame Lighters** (If your Prometheus lighter is not a torch flame lighter, you do not have to read this section.)

Your cigar or cigarettes should be lit with the top tip of the flame which is about one inch (25 mm) away from the flame hole. Do not put cigar or cigarette into the burning flame in order to prevent the ashes from falling into the flame hole and clogging it up.

Even though Prometheus Torch Flame lighters generate one-inch high flame, the lighter flame is barely visible. Consequently, keep your torch lighter away from your face when igniting.

**Note that Prometheus torch flame lighters might not ignite properly in a high altitude region (such as Mexico City, Swiss Alps, and Colorado and New Mexico of U.S.A.).** The paucity of oxygen at a high altitude prevents the electronic piezo of the lighter from functioning properly. Use Prometheus flint lighters in a high altitude region.

**VI. Care and Handling of Prometheus Flint and Electronic Piezo Lighters**

(If your Prometheus lighter is not a flint or electronic piezo lighter, you do not have to read this section.) If you are using **Prometheus flint lighters**, you need to put a new flint time to

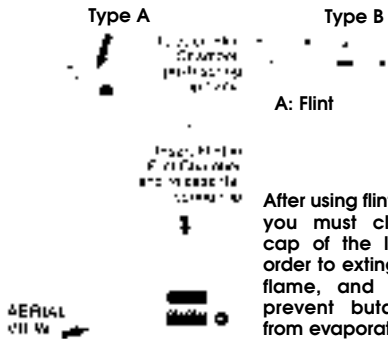

time when the lighter flint wears out. Prometheus flints can be purchased at premium tobacco shops worldwide. See above for the flint replacement instructions. Be sure that your lighter is fully extinguished before replacing flint.

**Like Prometheus torch flame lighters, Prometheus electronic piezo lighters might not function properly at a high altitude. Please use Prometheus flint lighters if you reside in high-altitude cities.**

**VII. Protecting Outer Case Finish** The outer case of Prometheus lighters are finely finished. In order to preserve the aesthetics of the outer case, do not carry lighter with coins or keys. Any damage to the outer case such as

scratch is not covered under the Prometheus Limited Warranty.

**VIII. Do-it-Yourself Maintenance Guide** We stand behind the quality of our Prometheus lighters by offering the Prometheus Limited Warranty. If you cannot correct the malfunctioning of your Prometheus lighter by following the maintenance table below, return your lighter directly to Prometheus Service Center for the warranty service by following the return instructions outlined in the warranty information (page 95).

PROBLEM	POSSIBLE CAUSE	SOLUTION
Lighter will spark but will not ignite.	Empty gas tank	Refill lighter
	Low-setting of flame adjuster.	Set flame height adjuster higher
	Mechanical malfunctions	Return for repair
Lighter will not spark.	Mechanical malfunctions	Return for repair
Flame jumps.	Air in gas tank	Take air out by bleeding tank (see refill instructions above)
	Mechanical malfunctions	Return for repair
Lighter makes hissing sound.	Gas tank leaks	Return for repair
	Flame height is too high	Set flame height adjuster lower

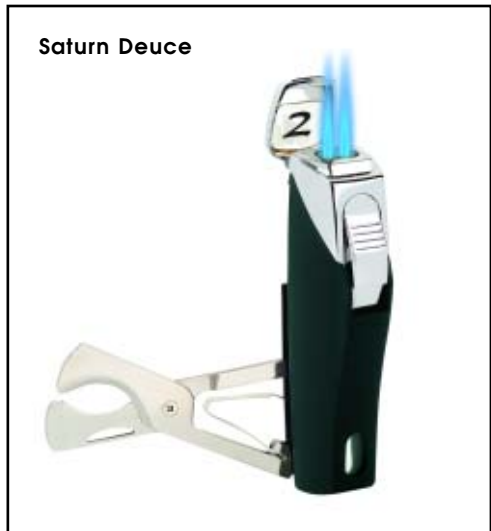

# Maintenance Tips for Torch Flame Lighters, Page 1 of 2

## Cleaning Flame Holes and Aligning Electronic Piezo Wire

The **Torch flame Lighters** have become the ultimate lighting instrument for many cigar smokers worldwide. Here are the quick maintenance tips for how to maintain the torch flame lighters on your own. Using these simple maintenance tips, you will be able to trouble-shoot most of the lighter problems, and do not inconvenience yourself with sending your lighter to Prometheus Service Center.

**I. The number one cause for the malfunction of the lighter is the clogged flame holes where the flame comes up.** When you light your cigars or cigarettes, do not put them into the burning flame in order to prevent the ashes from falling into the flame holes of the lighter. **If the flame holes are clogged, blow the compressed air into them in order to clean up the clogged flame holes.** The compressed air can be purchased at computer stores.



Clogged Flame Holes

Properly Maintained

The picture on the left side shows what happens to the lighter when cigarettes or cigars are lighted too close to the flame holes. The falling ashes clog up the flame holes of the lighter. Periodically, clean the flame holes with compressed air, which can be purchased at computer stores.



Compressed Air can be purchased at computer stores.



Too Close To Flame



One Inch Away from Flame Hole

In lighting cigars or cigarettes, light them with the top tip of the flame. Put your cigar 1 inch (25 mm) away from the flame holes. The best way to light your cigar is to light it with the heat from the flame but not with the flame itself so that you will not scorch the wrapper leave of your cigar.

**II. The second most common cause of the lighter malfunction is the misalignment of the electronic piezo wire.** The electronic piezo shoots out an electronic spark via its wire. When this electronic spark is shot directly to the upcoming butane gas, the flame is ignited. After the lighter is dropped to the ground many times or used for an extensive period of time, the position of the electronic piezo wire sometimes moves and becomes misaligned. When this happens, the electronic spark will not be shot directly to the center flame hole where the butane gas comes up and the flame will not be ignited.

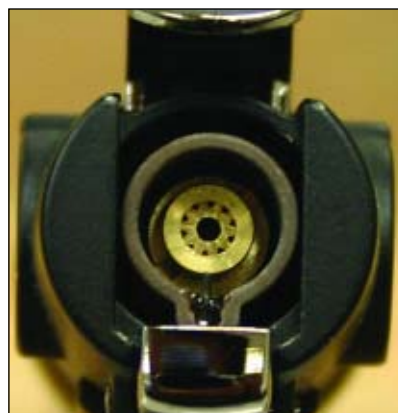
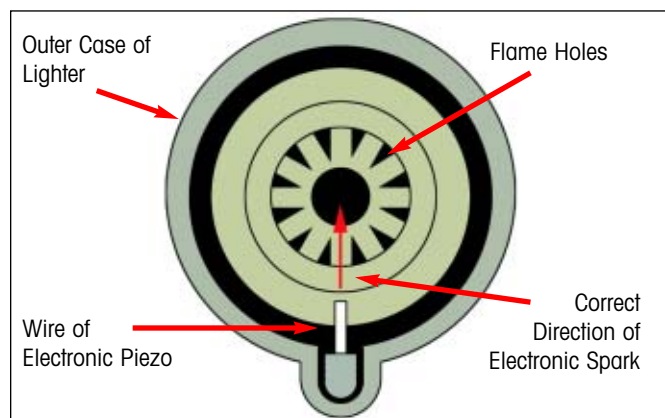

Click the ignition button and watch which direction the electronic spark is going. **If the spark is not going straight to the center flame hole as the RED ARROW direction above, use a ballpoint pen or a small screwdriver to GENTLY and CAREFULLY nudge the wire so that the electronic spark is going to the right direction.**

If the spark is not going to the center flame hole even after adjusting the wire position, the electronic piezo of your lighter might have to be replaced and you will have to send your lighter to Prometheus Service Center for the repair service.

# Maintenance Tips for Torch Flame Lighters, Page 2 of 2

## Adjusting Stopper Setting

III. If the flame of your Torch Flame lighter comes up low or does not come up at all, try adjusting the stopper setting. After you use Prometheus Torch Flame lighters for a certain period of time, the flame height might get shorter than your desired level or the flame will not come up any more even though you fill up the gas tank and turn up the flame height adjuster all the way to the maximum. This happens when the pressure of the gas tank drops. In this situation, do not try to turn the adjuster beyond the preset maximum level. If you force the adjuster to turn, you will damage the built-in stopper and your lighter will malfunction. Instead, open up the bottom of the lighter and take out **Rubber O-Ring** and **Stopper**. After this, adjust the flame height to your desired level and then, put **Stopper**, **O-Ring** and **Outer Case** back together. Turn the flame height adjuster by a quarter turn at a time until it reaches your desired level. **Be extremely cautious about the flame shooting up too high and do not turn the adjuster more than a quarter turn at a time. Hold away from your face while lighting.**

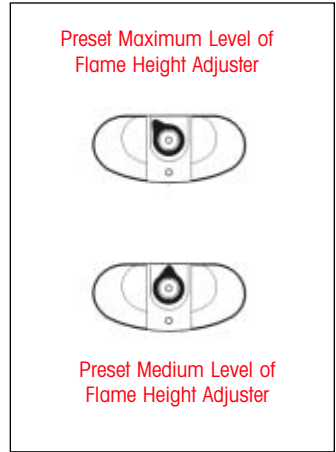
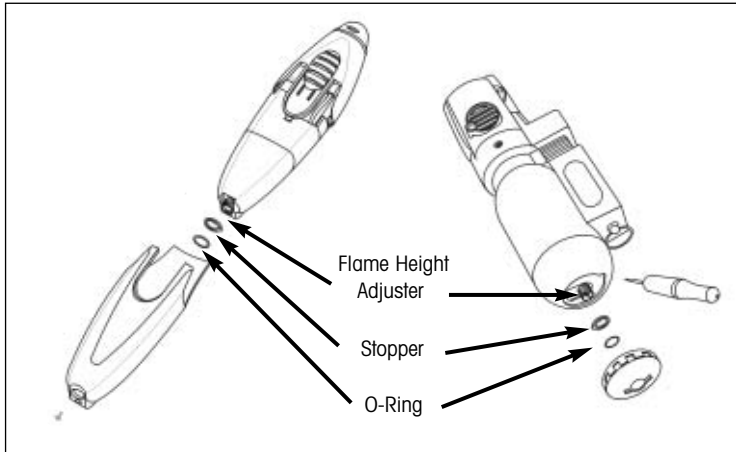

1. Unscrew the screw which holds the bottom cover to the gas tank.



2. Pull out the bottom cover from the lighter to get to the O-Ring and Stopper.

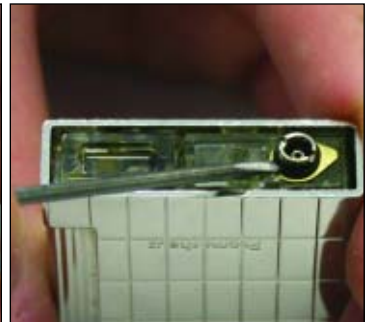

3. Remove the O-Ring from the Flame Height Adjuster.



4. Remove the Stopper below the O-Ring.

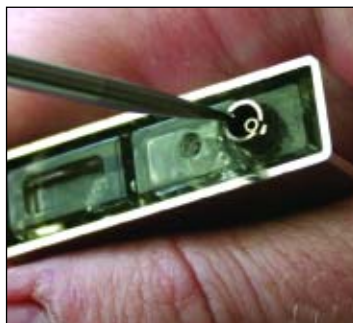

5. Turn the Flame Height Adjuster by a quarter turn at a time to the desired level.



6. Check the flame height before you put the Stopper, O-Ring and bottom cover back together.

## Construction of Torch Flame Lighter

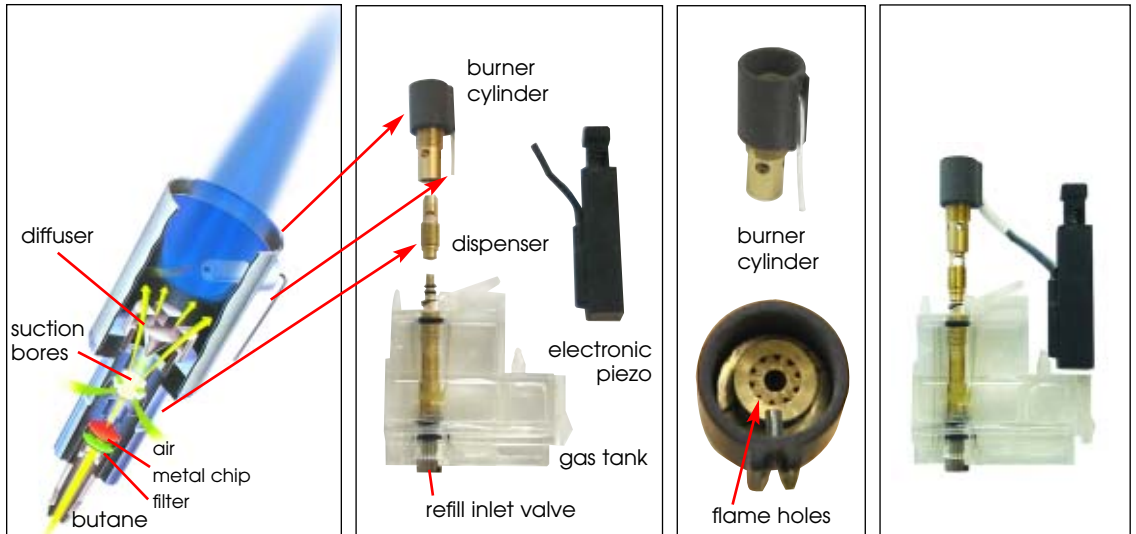

Prometheus torch flame lighters are electronic piezo lighters equipped with Burner Cylinder and Dispenser, which together form an internal gas combustion system.

When the ignition button is pressed down, butane gas is released from the gas tank. Inside of the dispenser, a metal chip with a very small hole in the center is installed. Through this small hole in the dispenser, butane gas is discharged with high pressure, and then, goes up through the flame holes in the burner cylinder for ignition. There are several flame holes: one in the center and a few surrounding the center. When ignition button is pressed, it not only releases butane gas but also generates an electronic spark from the electronic piezo. When the rapidly discharged butane gas comes in contact with electronic spark, a high temperature, blue flame is generated.

### Instructions and Warning:

We do not recommend using torch flame lighters for pipes. Due to its high temperature, torch flame can burn the briar of pipes.

When you light your cigars or cigarettes, please do not put them into the burning flame in order to prevent: 1) the ashes from falling into the flame holes and clogging them up; 2) the wrapper leaves of the cigar from being scorched. In lighting your cigars or cigarettes, put them 1 inch (25 mm) away from the flame hole and light them with the top tip of the flame.

Because it is difficult to see ignited flame in daylight, keep your torch lighter away from your face when igniting.

Given the high temperature of the flame, do not ignite torch lighters for an extended period of time. Also, do not use torch lighters for anything other than lighting cigars and cigarettes.

Prometheus torch lighters might not ignite in a high altitude region (such as Swiss Alps, Mexico City, Colorado (U.S.A.) and New Mexico (U.S.A.)). The paucity of oxygen at a high altitude can prevent the electronic piezo of the lighter from functioning properly. Please use Prometheus flint lighters in a high altitude region.

## Are Lighters Perishable?

Lighters are susceptible to mechanical malfunction if they are not used for a long period of time.

First, if a lighter is unused for a long period of time, Rubber O-Ring (A) around Refill Inlet Valve (B) will start disintegrate -- see the below picture for the illustration of the lighter parts. Rubber O-Ring hardens and the gas tank will leak from Refill Inlet Valve.

Furthermore, Molt Pran (C), which controls flame height, will also lose its effectiveness. Molt Pran is made out of a material similar to sponge and is inserted between Flame Height Adjuster (D) and Gas Nozzle (E), which is connected to Burner Cylinder (F). Depending on the setting of Flame Height Adjuster, Molt Pran is squeezed with a different level of pressure and controls how much gas goes up through Gas Nozzle (E).

If the lighter is not used for a long period of time, Molt Pran hardens. If this happens, you can no longer adjust the flame height. Furthermore, hardened Molt Pran blocks butane gas from going up through Gas Nozzle (E).

In order to prevent the above from happening, we strongly recommend you to periodically (once every three months) perform the following, simple maintenance procedures:

- 1) Drain and refill the gas tank in order to prevent Rubber O-Ring from hardening
- 2) After draining and refilling the gas tank, ignite the flame several times at the different settings of Flame Height Adjuster. This will prevent Molt Pran from hardening.

If the lighter is used regularly, all the lighter parts maintain their effectiveness.

Lastly, we highly recommend our dealers to sell the Prometheus lighters within 12 months from their purchase date. The collectors of the Prometheus lighter are recommended to use their Prometheus lighters periodically in order to prevent them from malfunctioning.

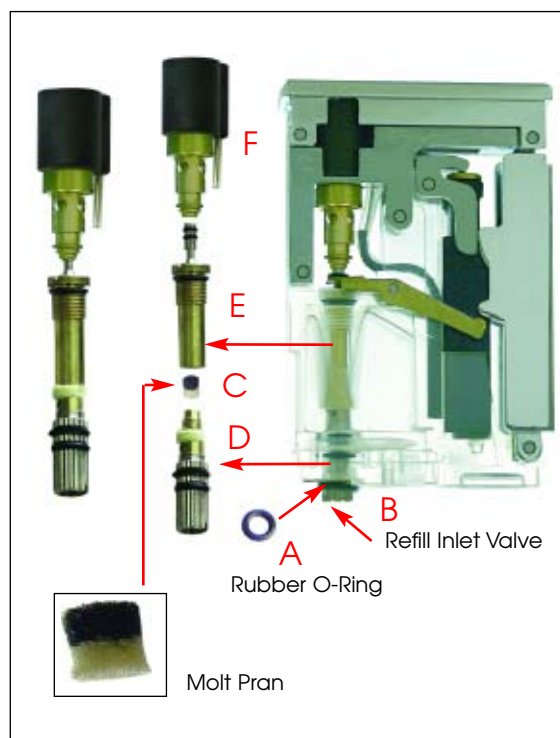

# Prometheus

## Lighter Travel Case

As a result of the passage of the Intelligence Reform and Terrorism Prevention Act of 2004, the Transportation Security Administration ([www.TSA.gov](http://www.TSA.gov)) banned lighters in commercial aircraft cabins, effective April 14, 2005. The Department of Transportation ([www.DOT.gov](http://www.DOT.gov)) has granted Prometheus with Special Permit (DOT-SP 14415) for its Lighter Travel Case. Now, you can put one flammable gas fueled lighter or one liquid (oil fluid) metal lighter in Prometheus Travel Case in your checked baggage, and travel with your lighter in commercial aircraft operating in the United States.

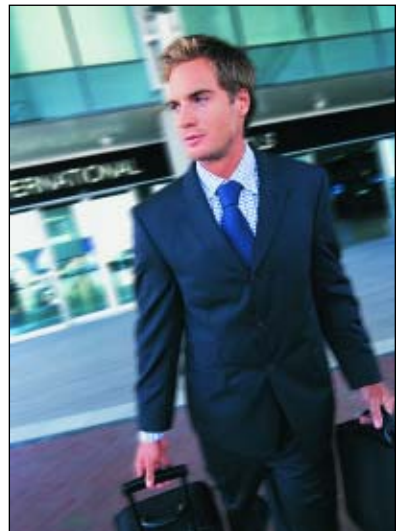

[www.prometheuskkp.com](http://www.prometheuskkp.com)



October 23, 2006

U.S. Department  
of Transportation

**Pipeline and Hazardous  
Materials Safety Administration**

400 Seventh Street, S.W.  
Washington, D.C. 20590

DOT-SP 14415

1. GRANTEE: Prometheus International, Inc.  
Commerce, CA
2. PURPOSE AND LIMITATION:
  - a. This emergency special permit authorizes the transportation in commerce of certain gas and liquid fueled lighters in checked baggage of passenger aircraft when packaged in a rigid, vapor-tight non-DOT specification solid plastic box that will prevent any movement of the lighter during transport.
8. SPECIAL PROVISIONS:
  - a. Each outer packaging, as described in paragraph 7 above, may not contain more than: one (1) approved flammable gas fueled lighter; or one (1) liquid (naphtha, Isopar-E, etc.) metal lighter. No passenger may carry more than two (2) outer packages in their checked luggage.

### **Prometheus Travel Case for Lighters**

Department of Transportation (DOT) has granted Prometheus with Special Permit (DOT-SP 14415) for its Lighter Travel Case. Now, you can put your flammable gas fueled lighter or liquid (oil fluid) metal lighter in Prometheus Travel Case, and travel with your lighter in commercial passenger aircraft operating in the United States.

#### **1) Can any brands of lighters go inside of Prometheus Travel Case?**

The following lighters can go inside of Prometheus Travel Case:

- All Prometheus lighters (DOT T-0458)
- All other butane gas lighters assigned with DOT T-number
- All liquid (oil fluid) metal lighter

**DOT T-number:** In order to transport their butane gas lighters via ground or air, manufacturers or importers must submit their lighters to Explosive Bureau for testing. Upon passing this test, DOT will assign a T-number to the lighters. There is one T-number for each lighter brand even though the lighter brand has more than one lighter model. [www.dot.gov](http://www.dot.gov)

#### **2) How many lighters can be packed in my checked baggage?**

One lighter per Prometheus Travel Case and two Prometheus Travel Cases per each checked baggage. **Prometheus Travel Case must be packed in checked baggage. You cannot carry your lighter in Prometheus Travel Case aboard an aircraft.**

## **Lighter Travel Case**

crushproof, airtight and waterproof up to 100 feet

made with ABS plastic reinforced with fiberglass

dimensions: 4.8 inches wide x 3.7 deep x 1.7 high (122 mm x 94 x 43)

### **CAUTION:**

**Prometheus Travel Case must be packed in checked baggage. You cannot carry your lighter in Prometheus Travel Case aboard an aircraft.**

**One lighter per Prometheus Travel Case and two Prometheus Travel Cases per each checked baggage.**

**Do not remove foam inserts.**

**Do not change or modify Prometheus Travel Case.**

**Lighter in this packaging conforms to DOT-SP 14415  
and may be transported in checked baggage by  
domestic passenger aircraft.**



## Lighter Travel Case

crushproof, airtight and waterproof up to 100 feet

made with ABS plastic reinforced with fiberglass

dimensions: 4.8 inches wide x 3.7 deep x 1.7 high (122 mm x 94 x 43)



**case-trv/bk**  
black



**case-trv/bl**  
blue